

AURARIA HIGHER EDUCATION CENTER MASTER PLAN UPDATE 2012

DRAFT





From Vision to Reality



Existing Conditions: Gross Square Footage: 2,554,670

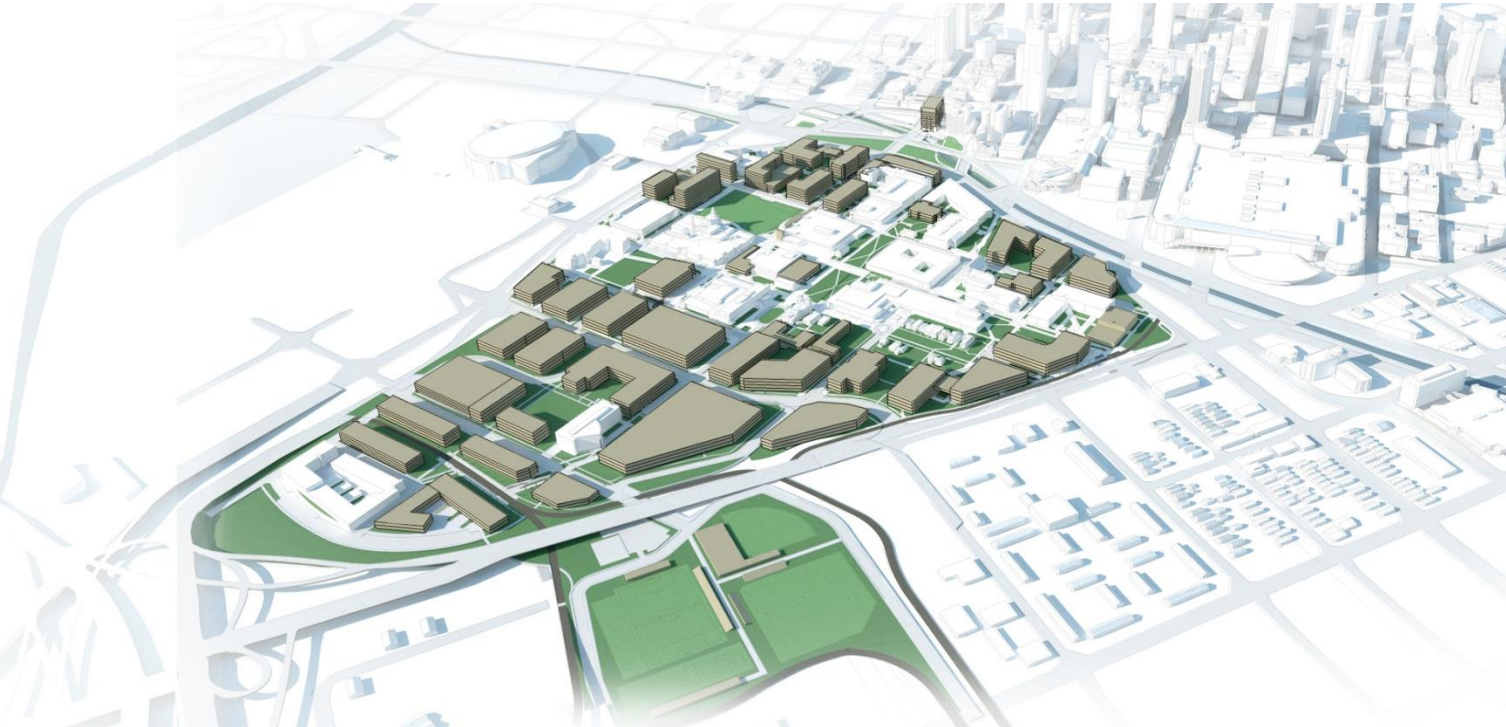

2012 Master Plan: Gross Square Footage: 7,300,000



Max Allowed per Zoning:
Gross Square Footage: 15,500,000



Downtown Density:
Gross Square Footage: 9,500,000



Transit-Oriented:
Gross Square Footage: 9,250,000

Shared Resources as Triggers for Growth.

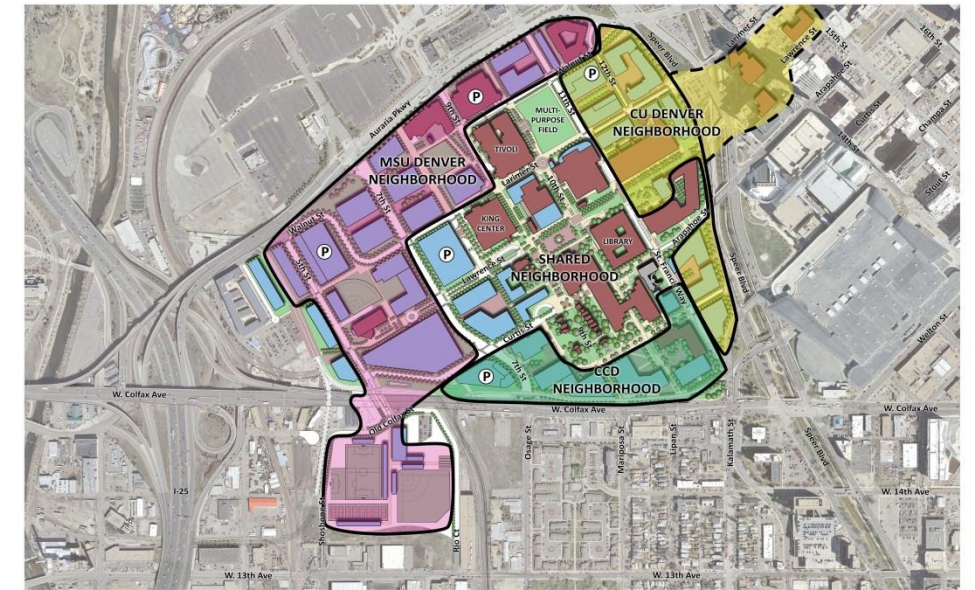
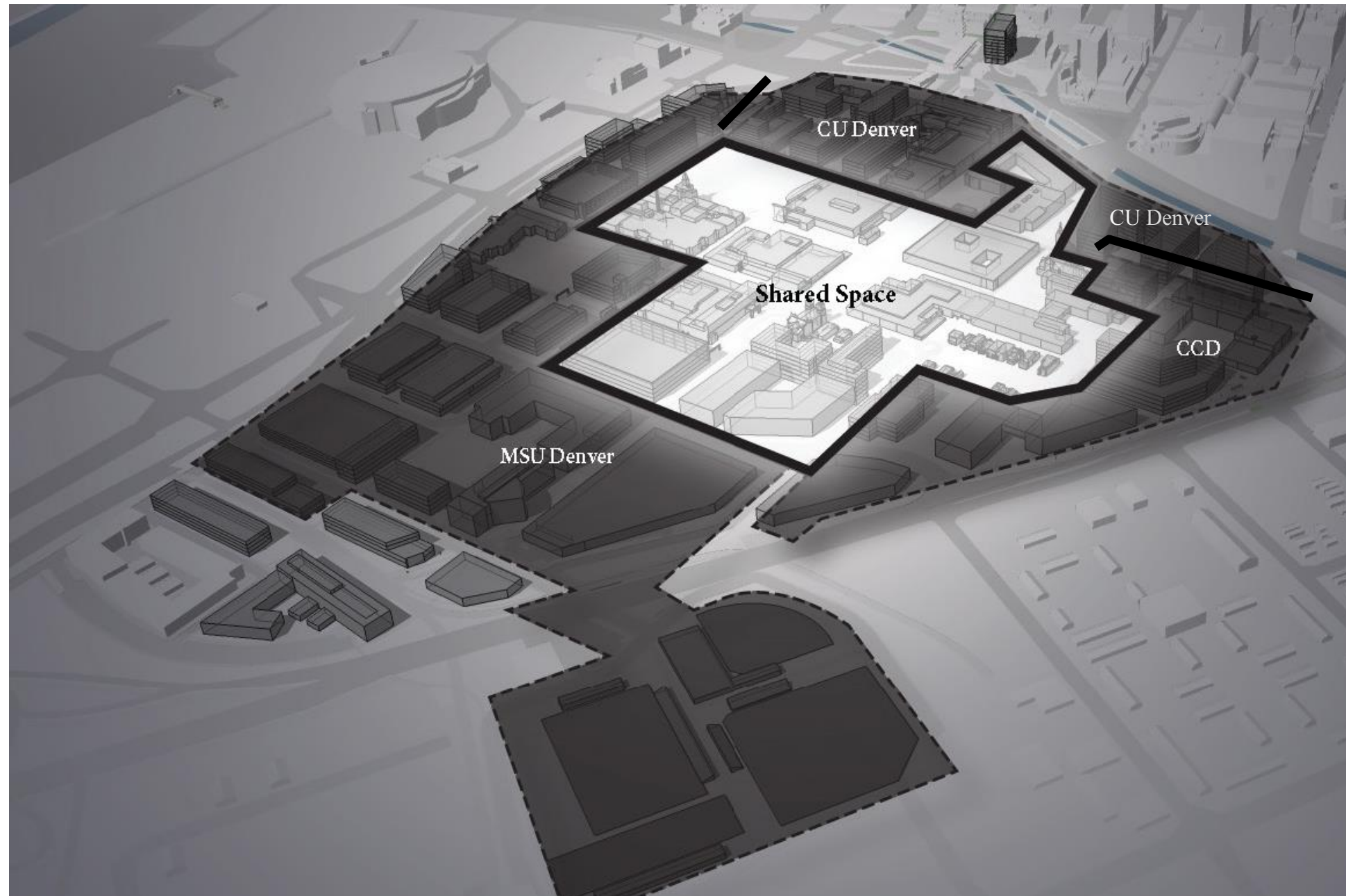

- ***Utilities***
- ***Parking***
- ***Shared Academic Buildings***
- ***Shared Corridors***
- ***Housing/Student Life***

Shared Academic Facilities

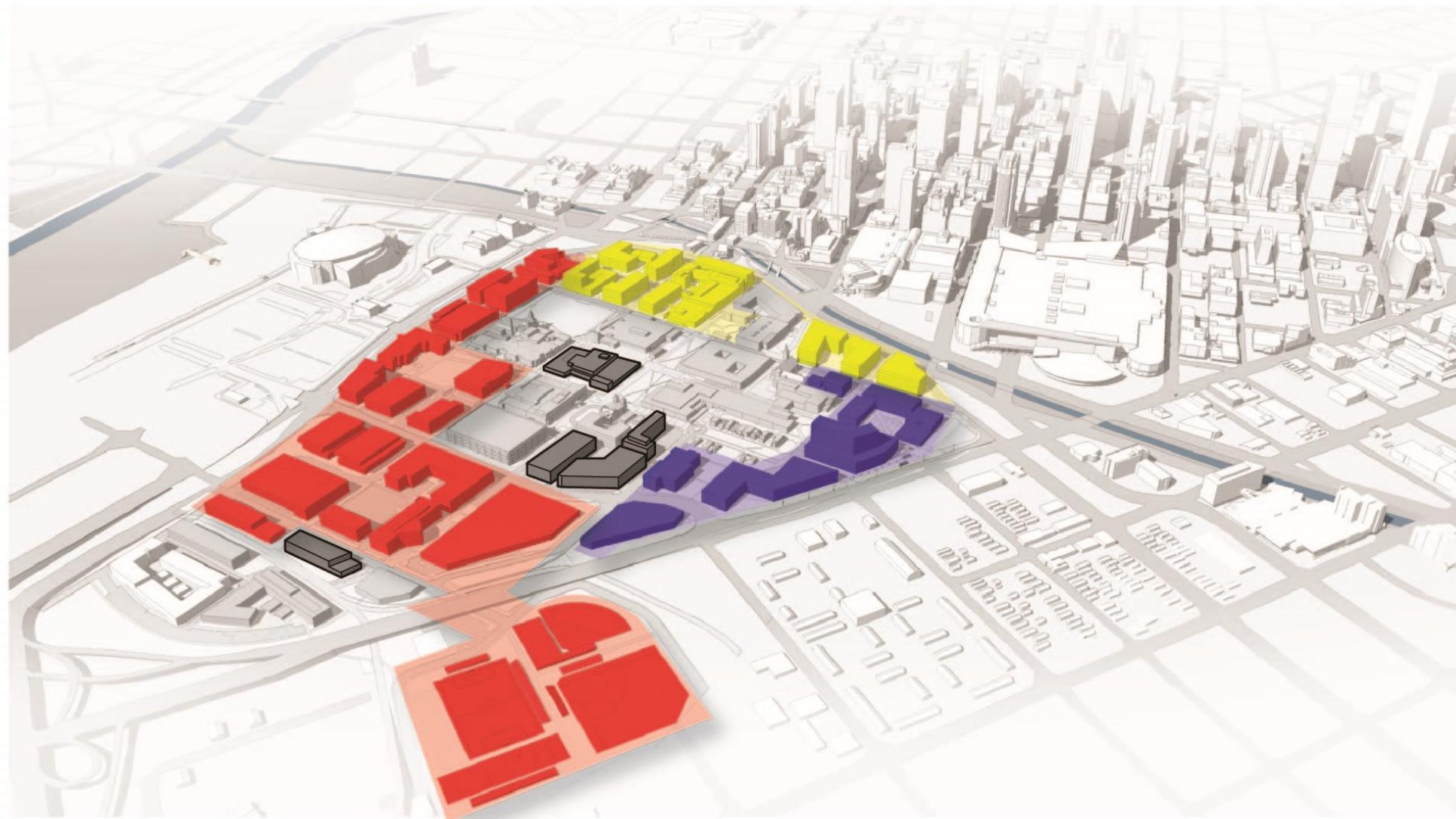

Opportunities for Shared Facilities

- *Engineering/Technology*
- *Arts*
- *Swing Space*
- *Incubator Space*

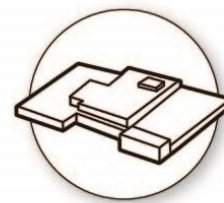
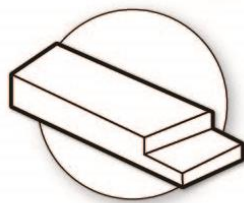

The Campus Today

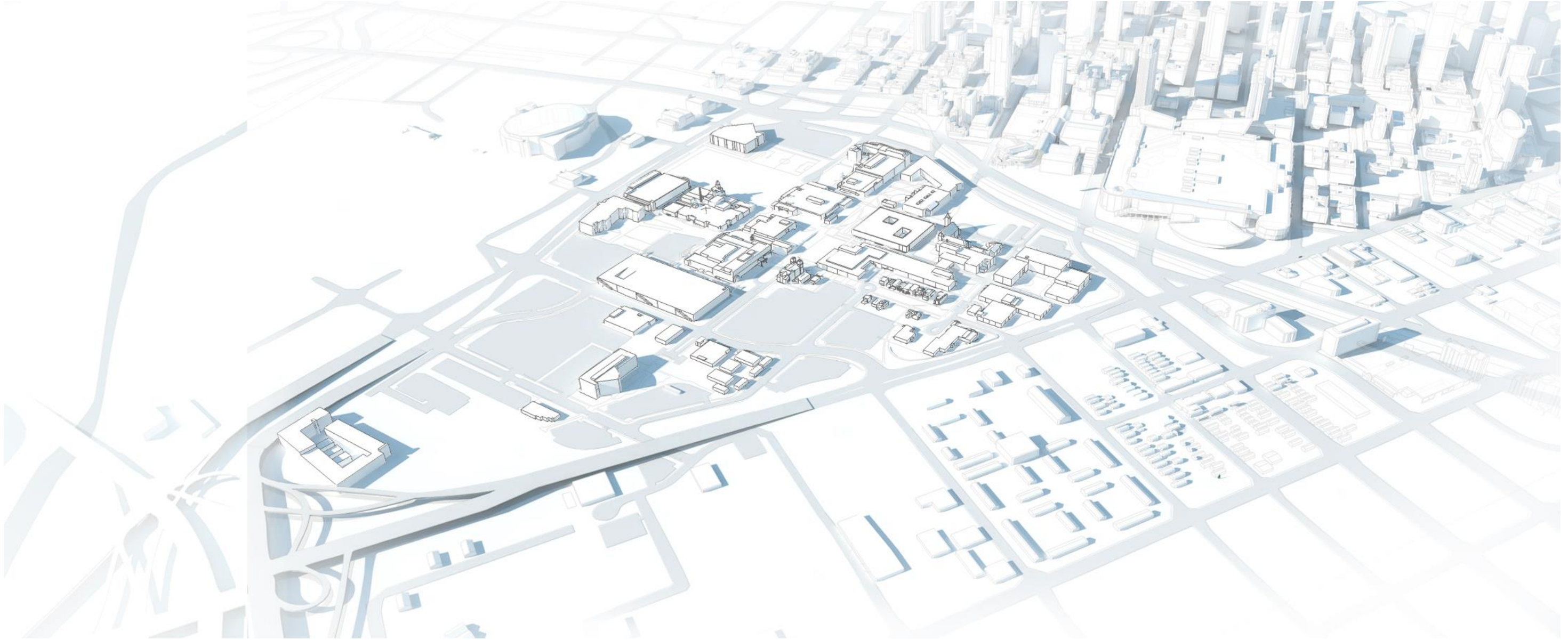

Phase 1. 0-5 Years.

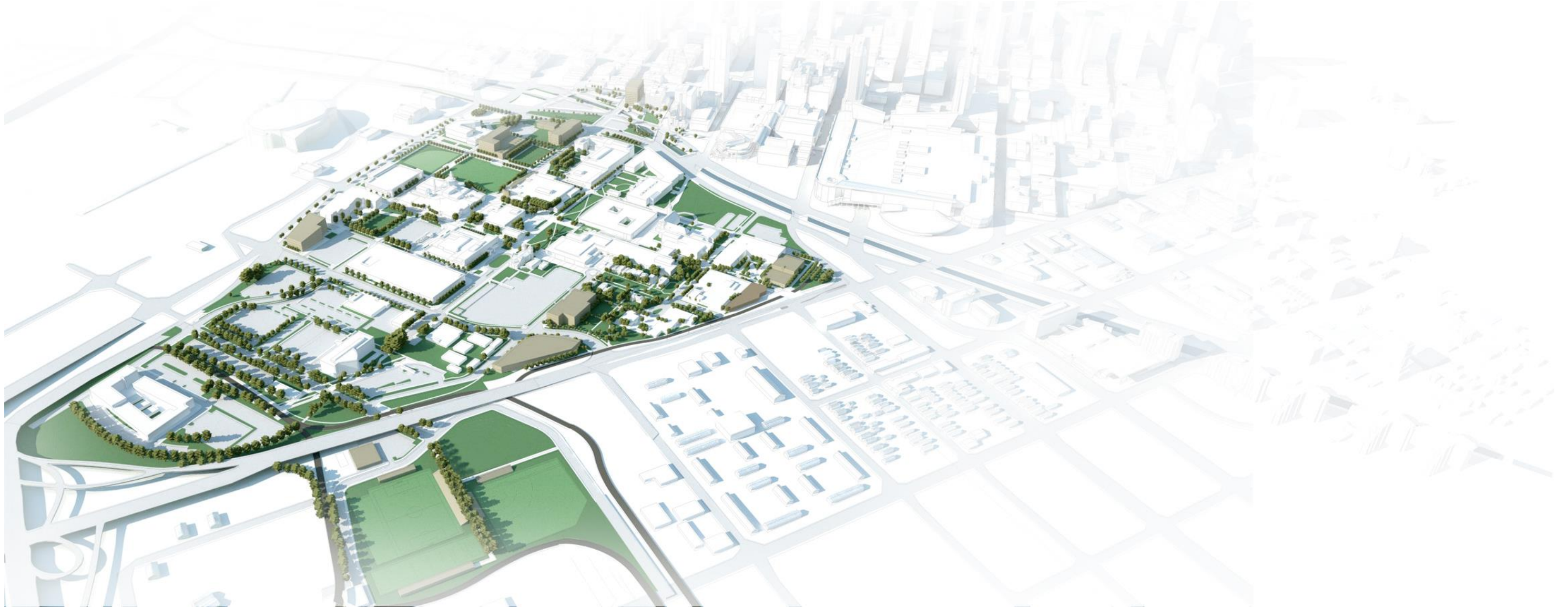

Phase 2. 6-10 Years.



Phase 3. 11+ Years.

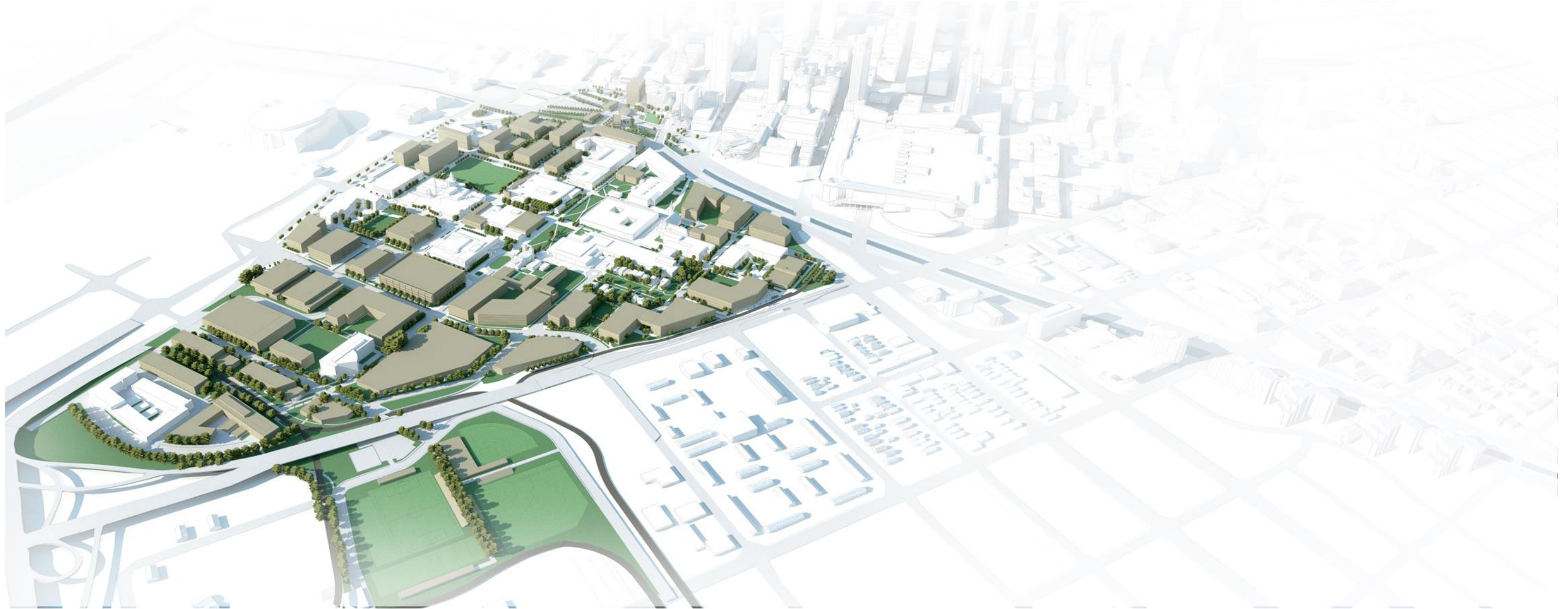

Auraria Edge



Auraria Parkway as a Pedestrian Friendly Gateway



5th Street

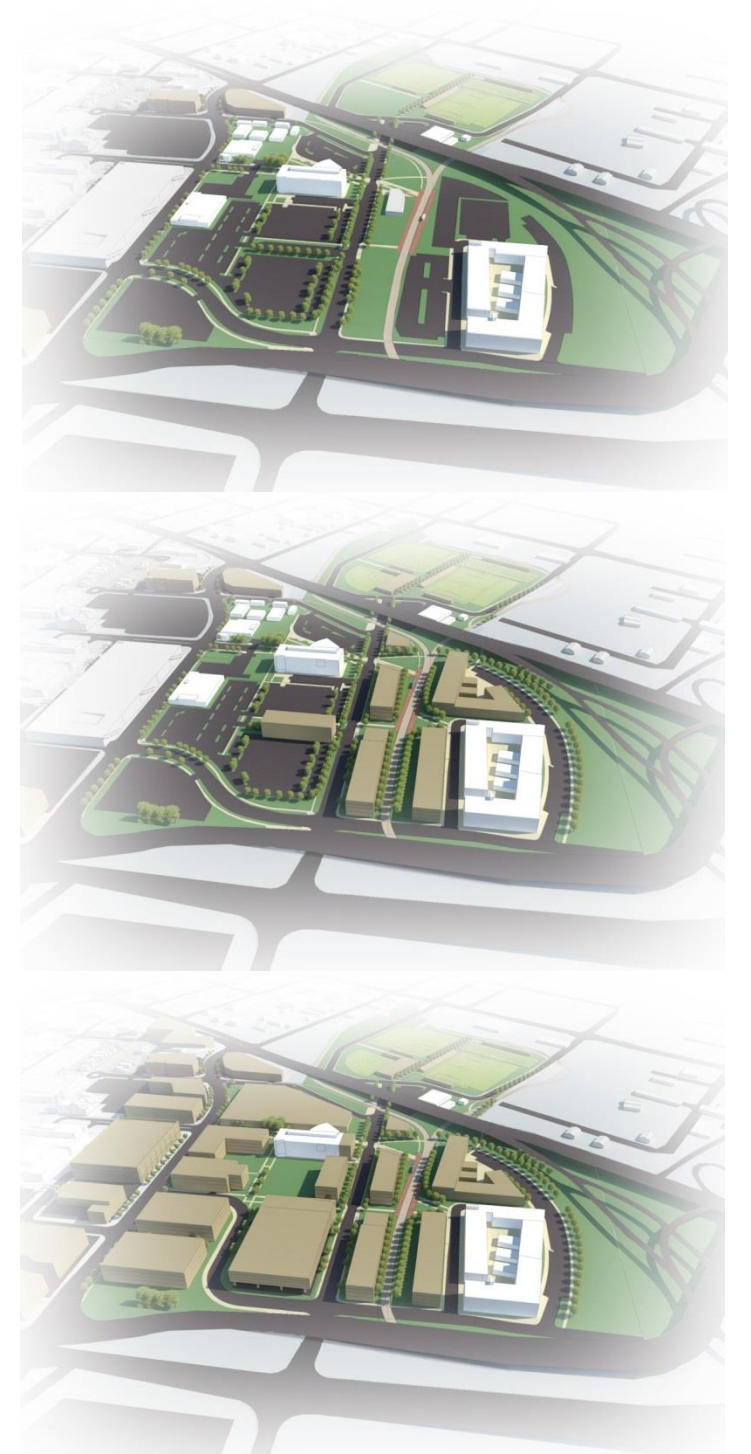
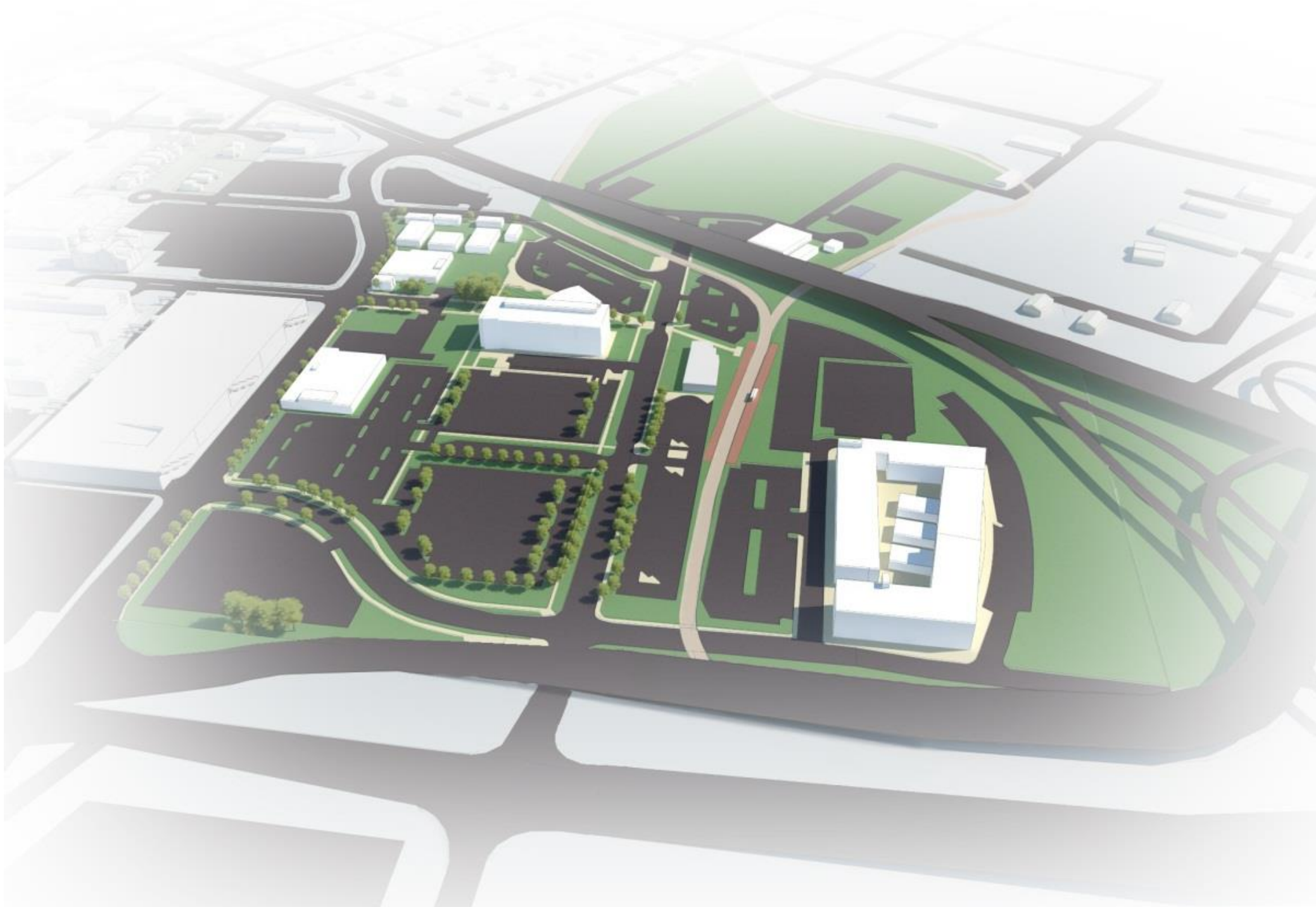

Active and Flexible Special Events Field



Activate the Edges

